

740-51129

carburetor components for

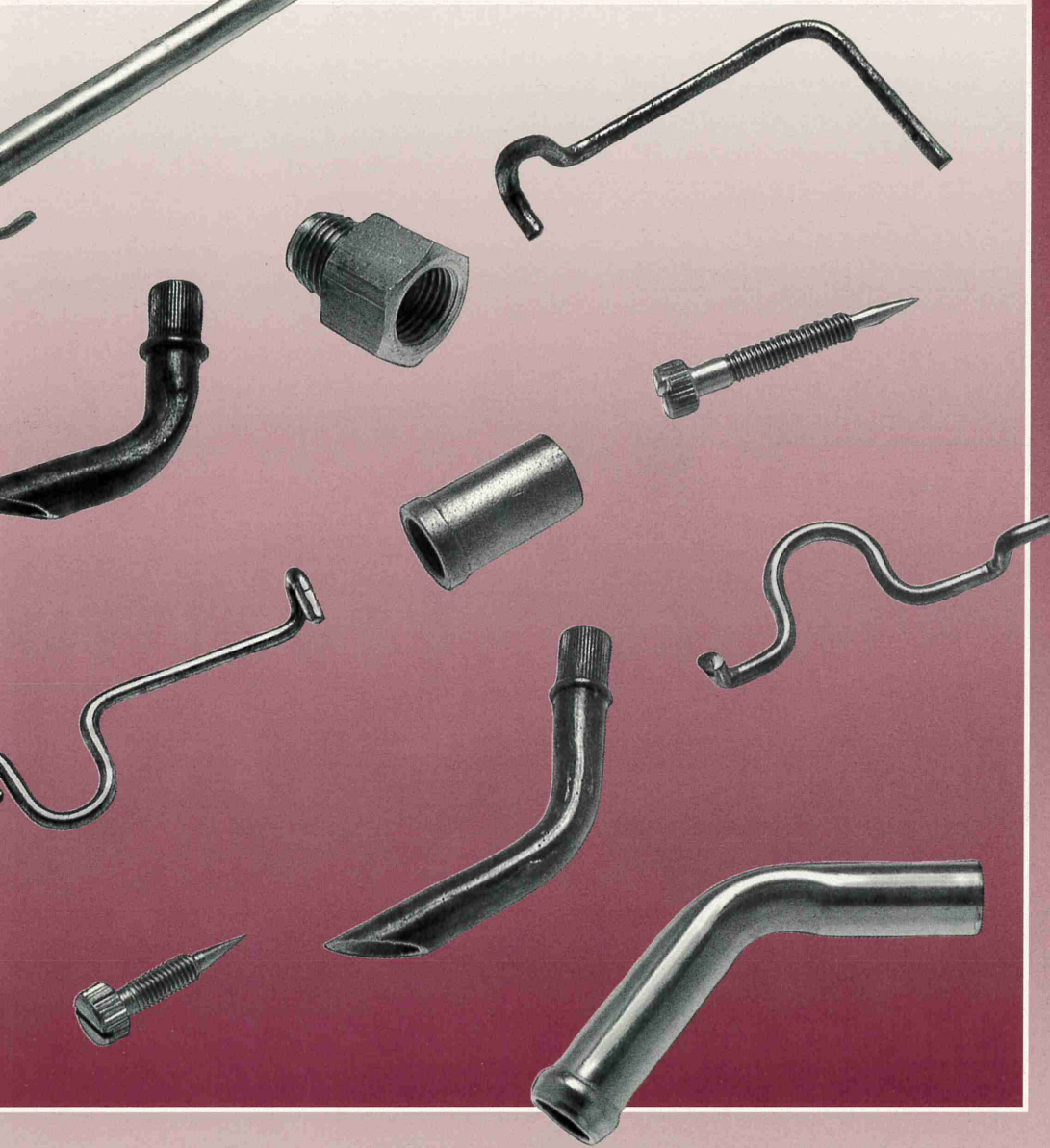

H O L L E Y

TABLE OF CONTENTS

MODEL	PAGE
1904, 1908, 1920, 1931, 1960	1-3
1909	4
1940, 1945, 1946, 1949, 6145, 6149	5-10
2209, 2210, 2245	11-13
2280, 6280	14
2300, C, EG, 2380EG	15-16
5200, C, 5210, C, 5220C	17-25
740, 5740C, 6740C	26-27
6500, C, 6510, C, 6520	28-29
3160, 4150, G, EG, 4160	30-34
4180, C, EG, 4190EG	35
4010, 4011	36
4500	36

Part Number to Page Number Index

ACE/KS NO.	PAGE	ACE/KS NO.	PAGE	ACE/KS NO.	PAGE	ACE/KS NO.	PAGE
C145-221	27, 29	H5-67	17	H15-64	15, 30	H24-8	1
C204-7	27	H5-68	17, 28	H15-64XX	15, 30	H24-20	1
F3-37	26	H10-45	15	H15-78	18	H24-25	12
F5-36	17	H10-46	15	H17-20	11, 30	H24-26	15, 31
F10-42	17	H10-47	30	H17-21	11	H24-29	6
F10-51	17	H10-58	17	H17-22	11	H24-30	1, 12
F25-20	18	H10-60	14	H17-30	5	H24-34	6
F28-32	19	H10-68	11	H17-31	5	H24-45	28
F61-51	19	H10-70	11	H17-33	18	H25-2	1
F145-135	21	H10-76	14	H17-34	18	H25-8	16, 31, 35
H2-10	5	H10-78	30	H17-44	5	H25-24	19
H2-11	11, 30	• H10-95	15	H17-45	5	H25-26	6
H2-23	26	• H10-97	15, 30, 35	H17-46	26	H28-18	12
• H3-45	15	• H10-98	18, 28	H17-47	15	H28-21	31
H5-38	17	• H10-99	18, 28	H17-48	28	H28-34	1
H5-39	17	• H10-100	18, 28	• H17-53	35	H28-51	6
H5-40	17	• H10-101	18, 28	• H17-54	35	H28-64	1
H5-44	17, 28	• H10-102	18, 28	• H17-55	35	H28-96	28
H5-45	15, 30, 35	• H10-103	36	• H17-56	30, 36	H28-97	6
H5-46	30, 35	H12-36		H19-2	1	H28-100	14
H5-49	5	H12-47	18, 28	H19-4	18, 28	H28-101	19
H5-51	17	H12-52	5	H22-1	1, 4, 5, 11, 15, 30	H28-104	19
H5-59	11	H12-53	26	H22-1S	1, 5, 11, 15, 30	H28-105	6
H5-60	11	H12-54	5	H22-16	1, 5, 11, 15, 31	• H28-107	26
H5-61	17	• H12-59	28	H22-66	6	H30-7	19
H5-62	17	H15-2	1	H22-67	6	H30-15	6, 19, 28
H5-63	26	H15-37	30	H22-68	26	H35-2	1
H5-64	30	H15-37X	30	H23-4	12	H35-8G	31

• Indicates a new part.

Part Number to Page Number Index (cont.)

ACE/KS NO.	PAGE	ACE/KS NO.	PAGE	ACE/KS NO.	PAGE	ACE/KS NO.	PAGE
H35-8G-G.....	31	H115-160.....	32	H145-85.....	13	H170-30.....	22
H35-9G.....	31	H115-164.....	32	H145-87.....	33	H170-32.....	23
H35-15G.....	31	H115-168.....	3	H145-88.....	21	H170-32A.....	23
H35-17.....	1	H115-190.....	3	H145-100.....	13	H170-34.....	23
H35-32.....	2	H115-198.....	32	H145-106.....	8	H170-37.....	23
H35-44.....	31	H115-201.....	7	H145-112.....	8	H170-42.....	29
H35-50G.....	19	H115-202.....	12	H145-120.....	8	H170-48.....	24
H35-58.....	26	H115-205.....	7	H145-124.....	13	H170-49.....	27
H35-62.....	14	H115-216.....	7	H145-126.....	13	H170-62.....	10
H35-68.....	19	H115-219.....	20	H145-132.....	33	• H170-63.....	24
H47-5.....	2, 16, 32	H115-221.....	13, 16	H145-133.....	33	H170-66.....	10
H47-8.....	4	H115-223.....	32	H145-155.....	8	• H170-80.....	24, 29
H47-13.....	2, 12	H115-225.....	33	H145-156.....	21	H170-81.....	27
H47-15.....	2	H115-244.....	20	H145-157.....	21	H170-82.....	10
H47-24.....	2	H115-251.....	20	H145-158.....	21	H170-88.....	27
• H47-44.....	16, 32	H115-252.....	20	H145-159.....	21	• H170-113.....	16, 34
H61-49.....	6	H115-253.....	33	H145-166.....	21	H186-11.....	34
H61-67.....	12	H115-254.....	33	H145-174.....	8	H186-24.....	14
H61-71.....	2	H115-260.....	20	H145-186.....	21	H186-25.....	24
H61-80.....	12	H115-267.....	20	H145-187.....	21	H186-44.....	10
H61-82.....	32	H115-273.....	7	H145-188.....	21	H186-45.....	10
H61-85.....	6	H115-296.....	3	H145-189.....	35	• H186-53.....	24
H61-88.....	19	H115-331.....	7	H145-195.....	22, 29	• H186-54.....	27
H61-89.....	16	H115-332.....	7	H145-198.....	8	• H186-55.....	36
H61-101.....	19	H115-339.....	13	H145-199.....	9	H201-9.....	24
H61-109.....	6	H115-340.....	13	H145-202.....	33, 35	H201-10.....	24
H61-122.....	32	H115-353.....	7	H145-204.....	22	H201-11.....	25
H61-125.....	19, 29	H115-354.....	7	H145-207.....	9	H201-12.....	10
H61-126.....	19	H115-355.....	7	H145-210.....	22	H201-13.....	25
• H61-145.....	29	H115-357.....	7	H145-211.....	22	H204.....	25
H63-2.....	6	H115-358.....	14	H145-218.....	9	H204-5.....	25
H63-3.....	2	• H115-373.....	29, 35	H145-223.....	27	H204-6.....	25
H63-6.....	2	H117-1.....	3	• H145-248.....	33, 35	H204-6A.....	25
H63-14.....	16, 32, 35	H117-7.....	4	H150-3.....	3, 9, 13, 14, 16, 22, 33	H204-8.....	14
H63-19.....	2	H117-10.....	3	H150-4.....	3, 33	H204-9.....	14
H63-20.....	2	H117-12.....	13	H150-22.....	16, 34	H204-9A.....	14
H63-21.....	2	H117-15.....	14	H150-32.....	22	H204-15.....	25
H63-23.....	6	H118-7.....	8	H150-33.....	13	H204-16.....	13
H63-25.....	16, 32, 35	H118-10.....	20	H150-39.....	9	HRP25-10.....	31
H63-26.....	12	H118-11.....	20	H150-57.....	9	HRP35-55.....	19
H63-27.....	12	H118-16.....	26	H160-10.....	9	HRP170-33.....	23, 29
H63-27B.....	6, 12	• H118-18.....	20	H160-11.....	9	R15-25.....	18, 28
• H63-40.....	16, 32, 35	• H118-19.....	20	H160-21.....	14	R145-75.....	3
• H75-36.....	26	• H118-21.....	8	H160-22.....	14	R170-31.....	23
H108-16.....	32	H145-2.....	33	H170-15.....	22	R170-31A.....	23
H108-19.....	7	H145-12.....	8	H170-20.....	22, 29	R170-31B.....	23
H108-22.....	12	H145-14.....	4	H170-22.....	22, 29	R170-31C.....	23
H108-27.....	16, 32	H145-59.....	33	H170-23.....	22, 29	R170-31D.....	23
• H108-38.....	32, 35	H145-66.....	3	H170-28.....	9	R170-31G.....	23
H115-90.....	2	H145-69.....	8	H170-28B.....	9	R170-31R.....	23
H115-128.....	2	H145-70.....	8, 21, 29, 33	H170-28C.....	9	RT-12.....	16, 34
H115-159.....	7, 12	H145-74.....	21	H170-28D.....	9	WE145-216.....	27

• Indicates a new part.



(800) 325-3888 • (316) 429-1000
 Hwy. 69 South • P.O. Box 151 • Columbus, KS 66725

ACE Electric Company, Inc. takes extensive measures to ensure the accuracy of descriptions and applications for each part represented in this publication. The sole intent of this catalog is to aid ACE/K.S. customers in the rebuilding of automotive aftermarket products. ACE assumes no responsibility for possible errors. Permission to reproduce any portion of this publication is denied.

HOLLEY

MODEL

1904, 1908, 1920, 1931, 1960



H15-2

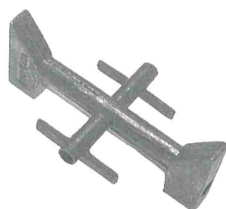

H19-2



H22-1



H22-1S



H22-16



H24-8



H24-20



H24-30



H25-2



H28-34



H28-64

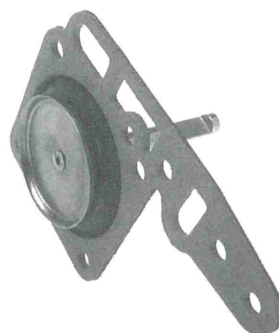

H35-2

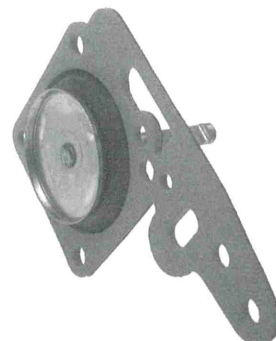

H35-17

ACE/KS No.	OEM No.	Description
H15-2	19R-146	Fitting, Fuel, 1952-61 Ford w/6cyl. eng.
H19-2	21R-647B	Cross Bar, Venturi
H22-1		Holder, Choke Wire Cable
H22-1S		Holder Only (for the H22-1)
H22-16		Holder, Choke Wire Cable
H24-8		Roll Pin, Solid Steel (for the H63-6) (1/16" dia. x 3/8" L)
H24-20		Roll Pin (1/16" dia. x 3/8" L)
H24-30	29R-814K	Pin, Float Hinge (3/32" dia. x 1-13/32" L)
H25-2		Kit, Cluster Repair
H28-34	15R-121	Screw, Idle Mixture
H28-64	15R-123K	Screw, Idle Mixture (replaces 15R-119)
H35-2	35R-313A	Pump, Diaphragm
H35-17	35R-863A	Pump, Diaphragm, 1968-69

HOLLEY

MODEL

1904, 1908, 1920, 1931, 1960

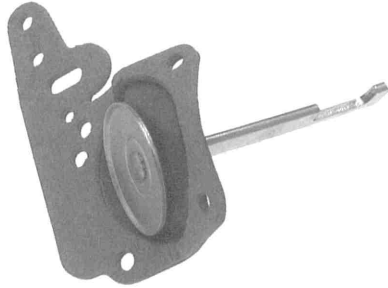

H35-32



H47-5



H47-13



H47-15



H47-24



H61-71



H63-3



H63-6



H63-19



H63-20



H63-21



H115-90



H115-128

ACE/KS No.	OEM No.	Description
H35-32	8-230	Pump, Diaphragm 1972 Dodge w/225" eng.
H47-5	7R-107	Plug, 1/4" Main Metering Body, 1957-61 Ford
H47-13		Plug (for the H23-4)
H47-15		Plug, Expansion (.500 O.D. x .080 deep)
H47-24	7R-583	Plug, Brass Cap (for the H28-22) (.255 O.D. x 5/16" deep)
H61-71	38R-1471K	Spring, Perk Valve Lever (for the H115-190)
H63-3	63R-469	Lever, Pump Operating
H63-6	63R-642	Lever, Power Valve
H63-19	63R-816	Lever, Power Valve
H63-20	63R-650	Lever, Pump
H63-21	63R-1027	Lever, Cluster
H115-90	43R-285	Rod, Air Vent
H115-128	33R-448	Link, Pump

HOLLEY

MODEL

1904, 1908, 1920, 1931, 1960



H115-168

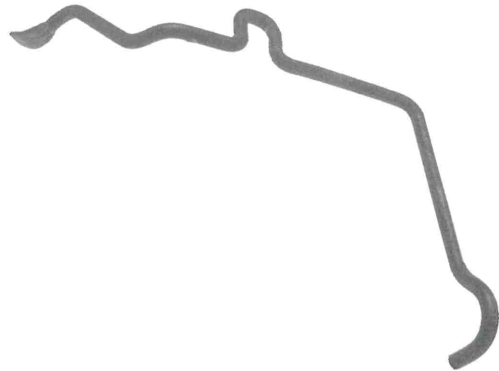

H115-190



H115-296



H117-1



H117-10



H-145-66



R145-75



H150-3



H150-4

ACE/KS No.	OEM No.	Description
H115-168	33R-485	Link, Vacuum Break
H115-190	43R-465	Lever, Perk Valve
H115-296	43R-467	Link, Fast Idle
H117-1	33R-368	Link, Pump, 1952-61 Ford, w/6cyl. eng.
H117-10	33R-443	Link, Pump (fits models with vacuum brake)
H145-66		Tube, 3/8" O.D. x 2-1/2" L
R145-75		Tube, 3/16" O.D. x 1-3/16" L
H150-3	36R-169	E-Clip (3/32")
H150-4	36R-225	E-Clip (5/64")

HOLLEY

MODEL

1909



H22-1



H47-8



H117-7



H145-14

ACE/KS No.	OEM No.	Description
H22-1		Holder, Choke Cable Wire
H47-8		Plug, Expansion (.450 diameter)
H117-7	33R-403	Link, Pump
H145-14		Tube, Vent (.1875 O.D. x 2-1/4" L)

HOLLEY

MODEL

1940, 1945, 1946, 1949, 6145, 6149

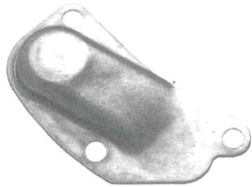

H2-10



H5-49

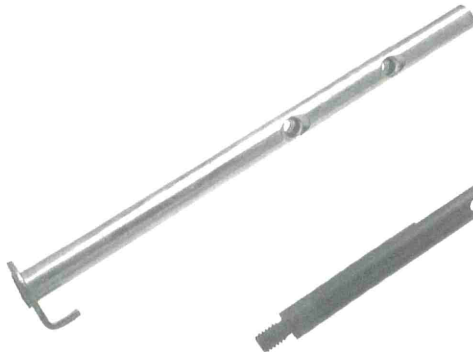

H12-52

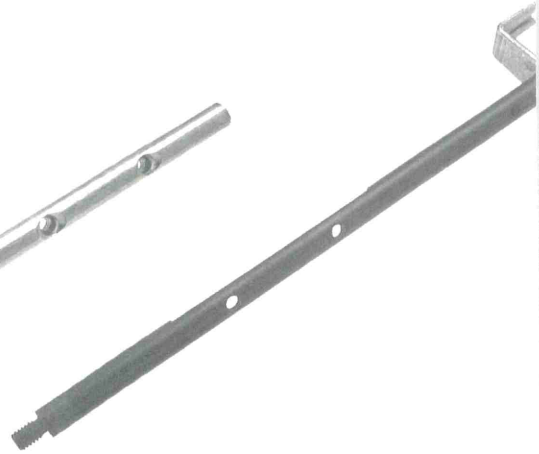

H12-54

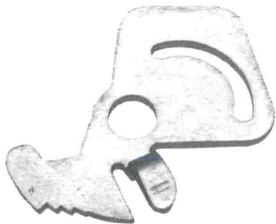

H17-30



H17-31



H17-44



H17-45



H22-1



H22-1S



H22-16

ACE/KS No.	OEM No.	Description
H2-10	34R-8440K	Cover, Canister Vent
H5-49	37R-308	Stud, Cam
H12-52	3R-577	Shaft & Lever Assy., Choke, 1962-69 Ford w/6 cyl. eng.
H12-54	3R-646	Shaft & Lever Assy., Choke, Ford w/6cyl. eng.
H17-30	41R-694	Cam, Fast Idle
H17-31	41R-720	Cam, Fast Idle
H17-44	41R-789A	Cam, Fast Idle, 1980 Ford, w/200 eng., A/T, w/o A/C
H17-45	41R-831A	Cam, Fast Idle, 1980 Ford, w/200 eng., all trans
H22-1		Holder, Choke Cable Wire
H22-1S		Holder Only (for the H22-1)
H22-16		Holder, Choke Cable Wire

HOLLEY

MODEL

1940, 1945, 1946, 1949, 6145, 6149



H22-66



H22-67



H24-29



H24-34



H25-26



H28-51



H28-97



H28-105



H30-15



H61-49



H61-85



H61-109



H63-2



H63-23



H63-27B

ACE/KS No.	OEM No.	Description
H22-66	4R-1160	Lever, Choke Pulldown, 1978-83 Ford, w/200 eng.
H22-67	4R-1339	Lever, Choke Pulldown, 1983-86 Ford, w/2.3L eng.
H24-29	36R-631K	Retainer, Float Shaft 1974 Dodge, w/198, 225 eng.
H24-34	40R-493	Weight, Pump Discharge Valve
H25-26	34R-8491	Retainer, Power Valve Diaphragm Body
H28-51	15R-149	Screw, Idle Mixture
H28-97	15R-217	Screw, Idle Mixture
H28-105	15R-200	Screw, Idle Mixture, 1980-81 Ford w/200 eng. (use spring H61-126)
H30-15		Filter, Screen (prevents blow-back to fuel bowl)
H61-49	38R-1311	Spring, Choke Modulator
H61-85	38R-1830	Spring, Power Valve
H61-109		Spring, Choke 1961-64 Ford, w/6cyl. eng.
H63-2	41R-390, 403	Cam, Fast Idle
H63-23	59R-122K	Retainer, Power Valve Rod
H63-27B	63R-1173	Lever Only (for the H63-27)

HOLLEY

MODEL

1940, 1945, 1946, 1949, 6145, 6149



H108-19



H115-159



H115-201



H115-205



H115-216



H115-273



H115-331

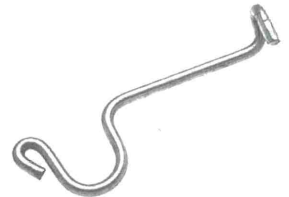

H115-332



H115-353

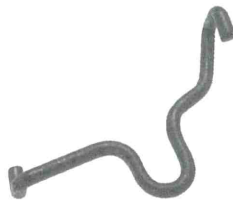

H115-354



H115-355



H115-357

ACE/KS No.	OEM No.	Description
H108-19	36R-707K	Retainer, Power Piston
H115-159	33R-492	Link, Pump
H115-201	33R-553K	Link, Choke Pull-Off, 1974 Chrysler Products w/6cyl. eng.
H115-205	33R-555	Link, Fast Idle
H115-216	43R-540K	Link, Choke
H115-273	33R-576	Link, Vacuum Brake
H115-331	33R-604	Link, Vacuum Brake, 1981-up Chrysler
H115-332	33R-553	Link, Choke Pull-Off, 1983-84 Dodge trk, w/2.8L, 3.2L, 3.7L eng.
H115-353	43R-746	Link, Fast Idle, 1980-81 Ford, w/200 eng.
H115-354	43R-657	Link, Fast Idle, 1978-80 Ford
H115-355	33R-614	Link, Pump, 1979-up Chrysler, w/6 cyl. eng.
H115-357	43R-602	Link, Fast Idle, 1979-up Chrysler, w/6 cyl. eng.

HOLLEY

MODEL

1940, 1945, 1946, 1949, 6145, 6149



H118-7

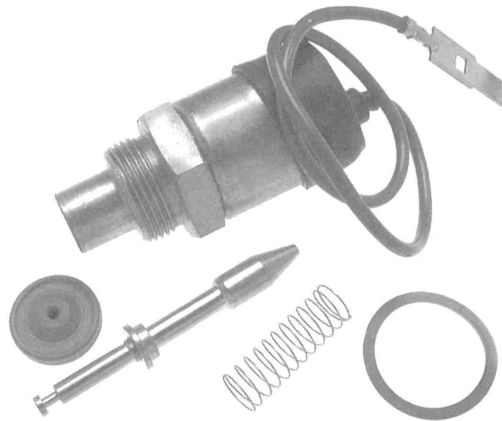

H118-21



H145-12



H145-69



H145-70



H145-106



H145-112



H145-120



H145-155



H145-174



H145-198

ACE/KS No.	OEM No.	Description
H118-7	34R-9334K	Cover, Hot Idle Compensator
H118-21	300R-204A	Solenoid, Bowl Vent
H145-12		Tube, Vent, Automatic Choke (1/4" O.D. x 5/8" L)
H145-69		Tube, Vacuum, (3/8" O.D. x 1- 5/16" L)
H145-70		Tube, Vacuum Conversion, (1/4" O.D. to 7/16" O.D. x 1-3/4" L)
H145-106	14R-988K	Tube, EGR, 1974-75 Chrysler, w/6 cyl. eng.
H145-112	14R-761-4AK	Tube, Idle (.031 orifice)
H145-120	14R-906K	Tube, Main Well
H145-155		Tube, (5/16" O.D. x 1-1/2" L w/flare)
H145-174		Tube, Canister, 1979-80 Chrysler, (5/16" O.D. to 1/4" O.D. x 2.00" L)
H145-198	14R-1112K	Tube, Pick-up, 1981 Ford

HOLLEY

MODEL

1940, 1945, 1946, 1949, 6145, 6149



H145-199



H145-207



H145-218



H150-3



H-150-39



H150-57



H160-10



H160-11

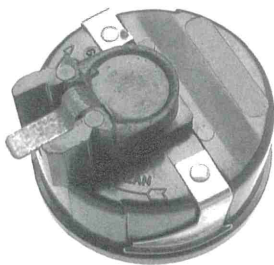

H170-28



H170-28B



H170-28C



H170-28D

ACE/KS No.	OEM No.	Description
H145-199	14R-1126K	Tube, Idle Pick-up, 1981 Chrysler
H145-207		Tube, Canister (3/8" nipple w/flare x 5/16" step down x 1.79" L)
H145-218		Tube, Step Conversion (1/4" to 5/16" x 1.60" L)
H150-3	36R-169	E-Clip, (3/32")
H150-39		Clip, Piston Retaining
H150-57		Pin, Throttle Lever (10-32 thd. x 3/16" stud x 3/4" L)
H160-10	25R-637K	Piston, Power, 1974 Chrysler w/225 eng.
H160-11	25R-682ASK	Power Valve and Seat Assy., 1977-up Chrysler
H170-28	47R-601AK	Thermostat, Electric Choke, 1979 Ford Passenger
H170-28B	47R-601AK	Bracket (Fits H170-28)
H170-28C	47R-601AK	Strap, Ground (Fits H170-28)
H170-28D	47R-601AK	Rivet (Fits H170-28)

HOLLEY

MODEL

1940, 1945, 1946, 1949, 6145, 6149



H170-62



H170-66



H170-82

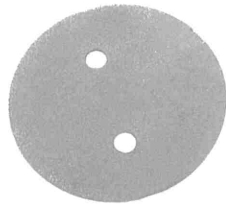

H186-44

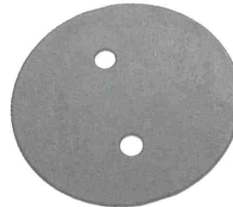

H186-45

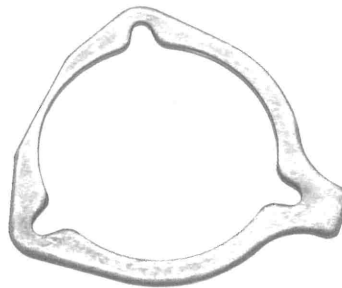

H201-12

ACE/KS No.	OEM No.	Description
H170-62		Sub-Assy., Electric Choke Thermostat
H170-66	40R-576-5	Spacer, Choke Index Ring, 1980-83 Ford Fairmont w/200 eng.
H170-82		Thermostat, Electric Choke
H186-44	9R-280	Plate, Throttle, 1981 Chrysler w/225 eng.
H186-45	9R-265	Plate, Throttle, 1975-80 Chrysler, Dodge w/225 eng.
H201-12	49R-1282	Ring, Retaining

HOLLEY

MODEL

2209, 2210, 2245



H2-11



H5-59

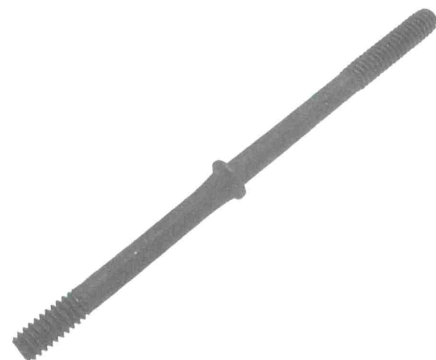

H5-60



H10-68



H10-70



H17-20



H17-21



H17-22



H22-1



H22-1S



H22-16

ACE/KS No.	OEM No.	Description
H2-11	23R-556	Valve, Vent
H5-59	37R-312-3	Stud, Air Cleaner (1/4-20 Thd. x 5-3/4" L)
H5-60	37R-312	Stud, Air Cleaner (1/4-20 Thd. x 4-1/2" L)
H10-68		Bushing, Throttle Shaft (.1875 O.D. x .1406 I.D. x .375 L)
H10-70		Bushing, Throttle Shaft (.250 O.D. x .1875 I.D. x .375 L)
H17-20	41R-613K	Cam, Fast Idle
H17-21	41R-646K	Cam, Fast Idle
H17-22	41R-635K	Cam, Fast Idle
H22-1		Holder, Choke Cable Wire
H22-1S		Holder Only (for the H22-1)
H22-16		Holder, Choke Cable Wire

HOLLEY

MODEL

2209, 2210, 2245



H23-4



H24-25



H24-30



H28-18



H47-13



H61-67



H61-80



H63-26



H63-27



H63-27B



H108-22

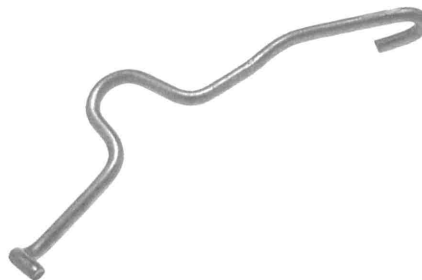

H115-159



H115-202

ACE/KS No.	OEM No.	Description
H23-4		Valve, Power (Small)
H24-25	25R-611, 631	Pin, Power Valve, 1974 Chrysler w/400 eng., A/T
H24-30	29R-814K	Pin, Float Hinge (.093" Dia. x 1-13/32" L)
H28-18	15R-137	Screw, Idle Adjustment, 1970 Chrysler w/383 eng., A/T
H47-13		Plug, Power Valve (fits our H23-4)
H61-67	25R-631	Spring, Power Valve, 1974 Chrysler w/400 eng., A/T
H61-80	38R-1472	Spring, Vent Valve
H63-26	63R-723	Lever, Pump
H63-27	63R-1174	Lever Assembly, Vent Valve
H63-27B	63R-1173	Lever Only (fits our H63-27)
H108-22	46R-833K	Washer, Pump Drive Spring
H115-159	33R-492	Link, Pump
H115-202	33R-539K	Link, Choke, 1971-Up Chrysler

HOLLEY

MODEL

2209, 2210, 2245



H115-221

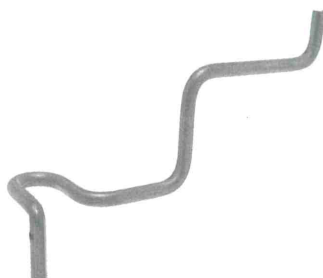

H115-339



H115-340



H117-12



H145-85



H145-100



H145-124



H145-126



H150-3



H150-33

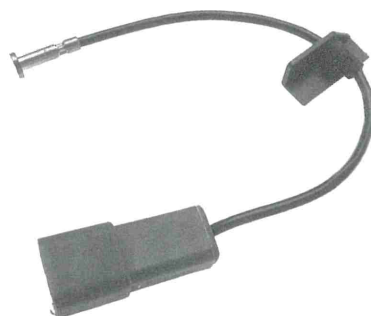

H204-16

ACE/KS No.	OEM No.	Description
H115-221	43R-264	Link, Hand Choke
H115-339	43R-365	Link, Choke
H115-340	43R-370	Link, Pump, 1965-69 Jeep
H117-12	67R-1205	Link, Pump Shaft
H145-85	14R-802A	Tube, High Speed Bleed (.027 head orifice size)
H145-100	14R-877	Tube, Main Well
H145-124	19R-541K	Tee (1/8" x 3/16" x 3/16")
H145-126	14R-802-3AK	Tube, Main Well
H150-3	36R-169	E-Clip (3/32")
H150-33		Stud, Cam
H204-16	71R-480AK	Stop & Cable Assembly, 1970-71 Chrysler

HOLLEY

MODEL

2280, 6280

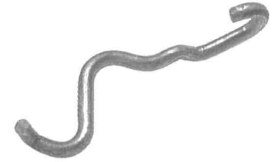

H10-60

H10-76

H28-100

H35-62

H115-358



H117-15

H150-3

H160-21

H160-22

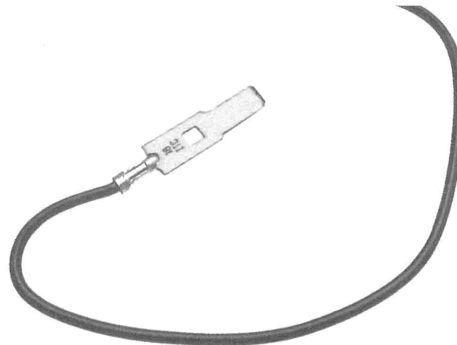
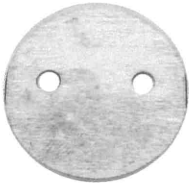

H186-24

H204-8

H204-9

H204-9A

ACE/KS No.	OEM No.	Description
H10-60		Bushing, Pump Stem Repair (.250 O.D. x .1875 I.D. x .165 L)
H10-76	7R-180	Restrictor, Idle (.097 O.D. x .020 orifice x .0938 L)
H28-100	15R-173	Screw, Idle Mixture 1978-80 Chrysler w/318 eng.
H35-62	30R-643A	Pump, Accelerator
H115-358	43R-677	Link, Fast Idle, 1978-79 Chrysler w/8 cyl. eng.
H117-15	33R-603	Link, Pump, 1978 Chrysler w/318 eng., A/T
H150-3	36R-169	E-Clip (3/32")
H160-21	25R-719ASK	Stem, Power Valve, 1978 Chrysler (.061 tip dia.)
H160-22	25R-718ASK	Stem, Power Valve, 1978 Chrysler (.084 tip dia.)
H186-24	9R-259K	Plate, Throttle, 1978-79 Chrysler w/318 eng.
H204-8	271R-61A	Connector, Throttle Position
H204-9	271R-61A	Wire and Terminal, Throttle Position (fits our H204-8)
H204-9A	271R-61A	Terminal Only, Throttle Position (fits our H204-8)

HOLLEY

MODEL

2300, C, EG, 2380EG

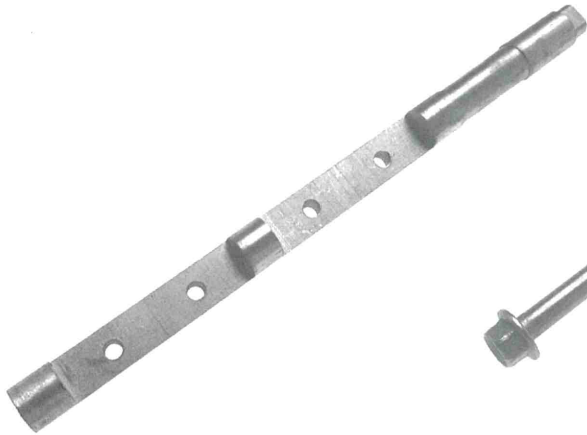

H3-45



H5-45



H10-45



H10-46



H10-95



H10-97



H15-64



H15-64XX



H17-47



H22-1



H22-1S



H22-16



H24-26

ACE/KS No.	OEM No.	Description
H3-45		Shaft, Throttle
H5-45	5R-552	Screw, Fuel Bowl - Primary
H10-45	13R-695K	Bushing, Shaft, Governor (.500 O.D. x .375 O.D. x .7188 L)
H10-46	13R-490	Bushing, Teflon Throttle Shaft (1/64" I.D. x 1/4" L)
H10-95	13R-1287K	Bushing, Throttle Shaft (.500 O.D. x .375 I.D. x .915 L)
H10-97	13R-1057K	Bushing, Throttle Shaft (w/governor)(.562 O.D. x .365 I.D. x .900 L)
H15-64	19R-227K	Fitting, Fuel Inlet, 1972 Ford (5/8-18 female 9/16-24 x 3/4" L)
H15-64XX		O.S. Fitting, Fuel Inlet (5/8-18 female inverted flare x 5/8-24 male)
H17-47	41R-539	Cam, Fast Idle
H22-1		Holder, Choke Cable Wire
H22-1S		Holder Only (for the H22-1)
H22-16		Holder, Choke Cable Wire
H24-26	29R-1208	Pin, Anti-Perk (.093 Dia. x 11/16L)

HOLLEY

MODEL

2300, C, EG, 2380EG

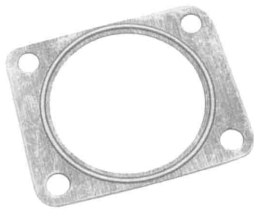

H25-8



H47-5



H47-44



H61-89



H63-14



H63-25



H63-40



H108-27



H115-221



H150-3



H150-22

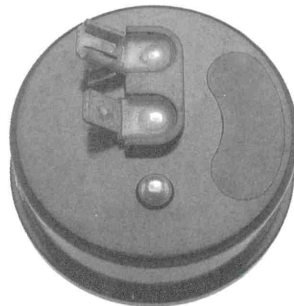

H170-113



RT-12

ACE/KS No.	OEM No.	Description
H25-8		Plate, Diaphragm Repair (spring steel)
H47-5	7R-107	Plug, Main Metering Body (1/4" Dia. x .155 Deep)
H47-44	25R-620BK	Plug, Power Valve
H61-89	38R-824	Spring, Throttle Return
H63-14	41R-218	Cam, Accelerator Pump (white)
H63-25	41R-427	Cam, Accelerator Pump (blue)
H63-40	41R-290	Cam, Accelerator Pump (green)
H108-27	46R-1021	Lockwasher, Spring Bushing
H115-221	43R-264	Link, Hand Choke
H150-3	36R-169	E-Clip (3/32")
H150-22		E-Clip (1/8")
H170-113	47R-669AK	Thermostat, Electric Choke
RT-12		Tap, Bottoming, 5/8-24 (for our H15-64XX)

HOLLEY

MODEL

5200, C, 5210, C, 5200C



F5-36



H5-38



H5-39



H5-40



H5-44



H5-51



H5-61



H5-62



H5-67



H5-68



F10-42



F10-51



H10-58

ACE/KS No.	OEM No.	Description
F5-36		Stud, Air Cleaner Repair, Pinto (M5 x .80 pitch x 1.00" L)
H5-38	37R-292K	Stud, Air Cleaner, Pinto & Vega (1/4-20 thd. x 2-5/8" L)
H5-39	37R-300K	Stud, Air Cleaner, Pinto (1/4-20 thd. x 2-1/4" L)
H5-40	37R-301K	Stud, Air Cleaner, Pinto (1/4-20 thd. x 2-3/8" L)
H5-44	37R-299K	Stud, Air Cleaner (1/4-20 x 2-3/8" L)
H5-51		Stud, Air Cleaner (fits Pinto) (1/4-20 thd. x 3-3/4" L)
H5-61	5R-1291	Screw, Airhorn Cover (M5 thd. x .80 pitch x .787" L)
H5-62	37R-318	Stud, Air Cleaner, 1978 Vega (1/4-20 thd. x 2-5/8" L)
H5-67	5R-1682	Screw, Throttle Plate (M4 x .70 pitch x .352" L)
H5-68	5R-1391	Screw, Idle Stop (use our spring 61-125)(10-32 thd. x 11/16" L)
F10-42		Bushing, Choke Shaft [in choke cvr](.3125 O.D. x .243 I.D. x 1/2" L)
F10-51		Bushing, Choke Shaft Repair (.3125 O.D. x .240 I.D. x 3/16" L)
H10-58		Bushing, Throttle Shaft Repair (.400 O.D. x .3125 I.D. x 3/8" L)

HOLLEY

MODEL

5200, C, 5210, C, 5200C



H10-98



H10-99



H10-100



H10-101



H10-102

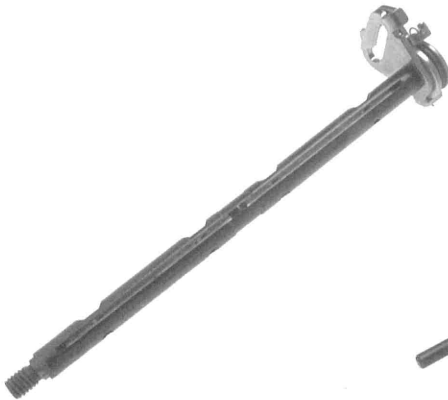

H12-36



H12-47



R15-25



H15-78



H17-33



H17-34



H19-4



F25-20

ACE/KS No.	OEM No.	Description
H10-98	13R-1178K	Bushing, Primary Throttle Shaft [throttle side]
H10-99	13R-1198K	Bushing, Secondary Return Spring
H10-100	13R-1199K	Bushing, Primary Return Spring [pump side]
H10-101	13R-1228K	Bushing, Choke Shaft Housing Lever
H10-102	13R-1285K	Bushing, Primary Throttle Shaft [pump side]
H12-36	3R-631K	Shaft, Choke, 1975-76 Vega
H12-47	4R-1081A	Shaft, Choke Housing, 1978-79 Mustang
R15-25		Fitting, Inlet (1/8 NPT x 3/8 Nipple)
H15-78	19R-567K	Fitting, Fuel Inlet, 1979-82 Chevette (1/2-20 female inverted flare x 7/8-20 male x 1.830" L)
H17-33	41R-745A	Cam, Fast Idle
H17-34	41R-697K	Cam, Fast Idle, 1972 Pinto
H19-4	21R-721-50	Nozzle, Pump Discharge
F25-20		Bracket, Float Pin Repair (Drill w/No. 29 Bit & Tap 8-32)

HOLLEY

MODEL

5200, C, 5210, C, 5200C



H25-24



F28-32



H28-101



H28-104



H30-7



H30-15

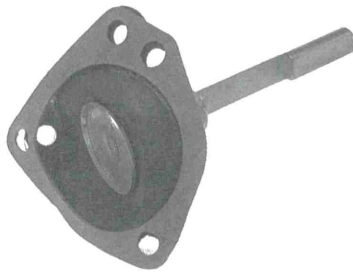

H35-50G



HRP35-55



H35-68



F61-51



H61-88

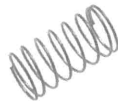

H61-101



H61-125



H61-126

ACE/KS No.	OEM No.	Description
H25-24		Bracket, Float Pin Repair
F28-32	22R-105K	Retainer, Idle Jet
H28-101	15R-184AS	Screw, Idle Mixture, 1979 Chevette (use our spring# H61-126)
H28-104	15R-198K	Screw, Idle Mixture (use our spring# H61-126)
H30-7	57R-61AK	Filter, Fuel Inlet
H30-15		Screen, Filter (helps prevent blowback to fuel bowl)
H35-50G	35R-1071A	Diaphragm, Choke Pull-off, (w/gasket attached)
HRP35-55	25R-568, 583	Actuator, Power Valve (repair kit)
H35-68	25R-583K	Actuator, Power Valve
F61-51	38R-1834	Spring, Throttle Return, Pinto
H61-88	48R-99	Clip, Retainer (1/32")
H61-101	38R-1537	Spring, Choke Diaphragm
H61-125	38R-108	Spring, Idle Mixture Screw & Idle Stop Screw (fits our H5-68)
H61-126	38R-1953	Spring, Idle Mixture Screw (fits our H28-101, 104, 105)

HOLLEY

MODEL

5200, C, 5210, C, 5200C



H115-219



H115-244



H115-251



H115-252



H115-260



H115-267

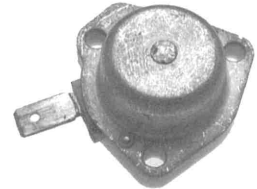

H118-10



H118-11

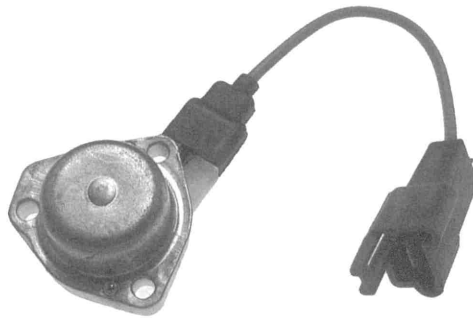

H118-18

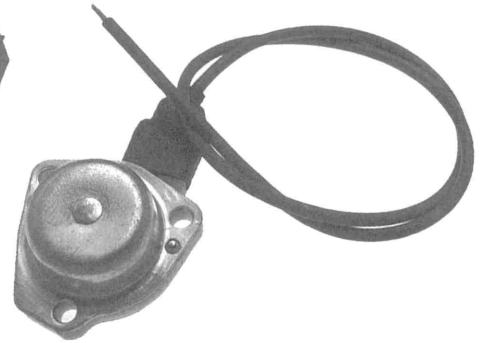

H118-19

ACE/KS No.	OEM No.	Description
H115-219	43R-488K	Link, Choke, Pinto
H115-244	43R-584K	Link, Choke, Vega
H115-251	43R-489K	Link, Fast Idle, Pinto
H115-252	43R-587K	Link, Choke Lever
H115-260	43R-523K	Link, Fast Idle
H115-267	43R-569K	Link, Fast Idle, Vega
H118-10	300R-28A	Solenoid, Bowl Vent
H118-11	300R-99AK	Solenoid, Bowl Vent, Chrysler w/4 cyl. eng.
H118-18		Solenoid, Bowl Vent
H118-19		Solenoid, Bowl Vent

HOLLEY

MODEL

5200, C, 5210, C, 5200C



H145-70



H145-74



H145-88



F145-135



H145-156



H145-157



H145-158



H145-159



H145-166



H145-186



H145-187



H145-188

ACE/KS No.	OEM No.	Description
H145-70		Tube, Vacuum Conversion (1/4" to 7/16")
H145-74		Tube, Fuel Inlet, Pinto (3/16" O.D. x 1-1/4" L)
H145-88		Tube, CCU, Vega (3/8" O.D. x 2-3/8" L)
F145-135		Tube, Choke Housing Restriction (.156 O.D. x .100 I.D. x 1/4" L)
H145-156	14R-1061-50	Tube, Primary Idle Restriction (stamped 50--.0225 orifice)
H145-157	14R-1061-46	Tube, Primary Idle Restriction (stamped 46--.022 orifice)
H145-158	14R-1061-54	Tube, Primary Idle Restriction (stamped 54--.0236 orifice)
H145-159	14R-1061-38	Tube, Primary Idle Restriction (stamped 38--.021 orifice)
H145-166		Tube, Diverter, Late Model Ford (3/16" dia.)
H145-186		Tube, Fuel Restrictor (.133 O.D. x .081 I.D. x .240 L)
H145-187		Tube, Fuel Restrictor (.133 O.D. x .055 I.D. x .240 L)
H145-188	14R-1061-74	Tube, Primary Idle Restriction (stamped 74--.0284 orifice)

HOLLEY

MODEL

5200, C, 5210, C, 5200C



H145-195



H145-204



H145-210



H145-211



H150-3



H150-32



H170-15

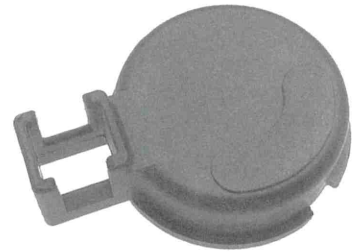

H170-20



H170-22

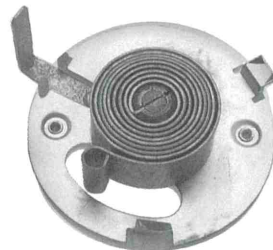

H170-23



H170-30

ACE/KS No.	OEM No.	Description
H145-195		Tube, Choke Diaphragm Cover (.1875 O.D. x .047 I.D. x 7/8" L)
H145-204		Tube, Vacuum (.1875 O.D. to .145 O.D. x 1.00" L)
H145-210		Tube, Choke Diaphragm Cover (.1875 O.D. x .028 orifice x 1.00" L)
H145-211		Tube, Distributor Vacuum (.150 O.D. to .200 O.D. x 1.00" L)
H150-3	36R-169	E-Clip (3/32")
H150-32	29R-1199	Stud, Sec. Return Spring (1/4-20 thd. x .200" stud O.D. x 1.00" L)
H170-15	47R-413A	Choke Assist Unit, Electric
H170-20	47R-487K	Cover, Choke
H170-22	47R-512AK	Spacer, Blue Plastic
H170-23	47R-517AK	Spring Assembly, Bi-metal Choke
H170-30	34R-7128K	Jacket, Choke Housing Water, Pinto

HOLLEY

MODEL

5200, C, 5210, C, 5200C



R170-31



R170-31A



R170-31B

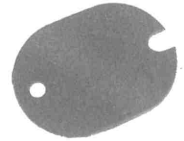

R170-31C



R170-31D



R170-31G



R170-31R



H170-32

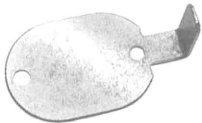

H170-32A



HRP170-33



H170-34



H170-37

ACE/KS No.	OEM No.	Description
R170-31	17056150	Cover, Electric Choke
R170-31A	17056150	Rivet No. A-1, Oval Head (1/4" L)
R170-31B	17056150	Rivet No. B-1, Oval Head (5/16" L)
R170-31C	17056150	Cover, Fiber Contact
R170-31D	17056150	Rivet, Steel (3/8" L)
R170-31G	17056150	Connector Tab, Electric Choke
R170-31R	17056150	O-ring, Choke Cover (1-1/4" O.D. x 1-1/8" I.D.)
H170-32	47R-605A	Cover, Electric Choke, 1980 Plymouth w/4 cyl. eng., w/wo A/C
H170-32A	47R-605A	Connector Tab, Electric Choke
HRP170-33	47R-605A	Repair Part, Use Epoxy To Repair Connector
H170-34	34R-8427	Jacket, Choke Housing Water
H170-37	47R-441AK	Thermostat, Choke, 1971-75 Ford w/2.0 & 2.5L eng.

HOLLEY

MODEL

5200, C, 5210, C, 5200C



H170-48



H170-63



H170-80

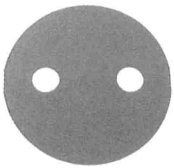

H186-25

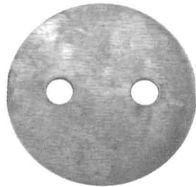

H186-53



H201-9



H201-10

ACE/KS No.	OEM No.	Description
H170-48	47R-553	Cover, Electric Choke Thermostat
H170-63		Sub- Assy, Electric Choke Thermostat
H170-80		Thermostat, Electric Choke
H186-25	9R-232K	Plate, Throttle
H186-53	9R-231K	Plate, Throttle
H201-9	49R-1278K	Ring, Choke Retaining
H201-10	49R-1471	Ring, Choke Retaining Ground

HOLLEY

MODEL

5200, C, 5210, C, 5200C



H201-11

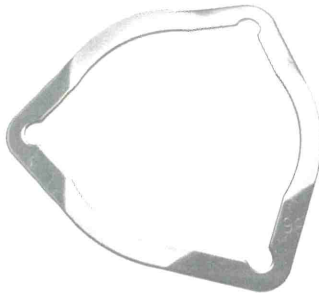

H201-13



H204

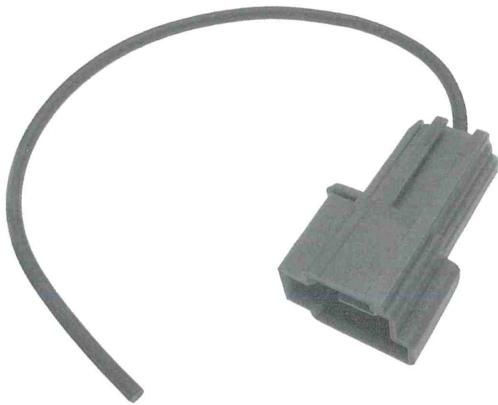

H204-5



H204-6



H204-6A

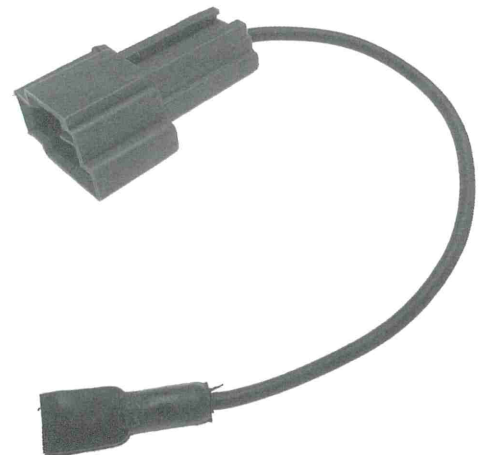

H204-15

ACE/KS No.	OEM No.	Description
H201-11	49R-1440K	Ring, Choke Retaining Ground
H201-13	49R-1466K	Ring, Choke Retaining
H204	47R-413A	Wire & Terminal Only (fits our H170-15)
H204-5	47R-616K	Connector, Wire & Terminal, 1979 Chevette
H204-6	47R-616K	Wire & Terminal, 1979 Chevette
H204-6A	47R-616K	Plug Only, Plastic
H204-15		Connector Assembly, Wire & Terminal

HOLLEY

MODEL

740, 5740C, 6740C



H2-23



F3-37



H5-63



H12-53



H17-46



H22-68



H28-107



H35-58



H75-36

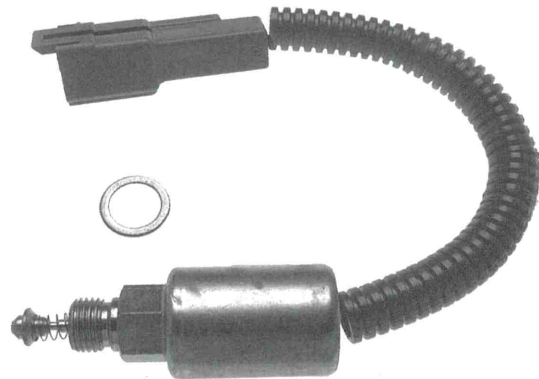

H118-16

ACE/KS No.	OEM No.	Description
H2-23	39R-339-2	Nut, Fast Idle Adjusting (M5 x .50 pitch)
F3-37	63R-1326K	Lever, Throttle Shaft
H5-63	5R-1603K	Screw, Fast Idle Adjusting
H12-53	4R-1241K	Lever, Dechoke, 1981-86 Ford Escort, Fiesta
H17-46	41R-836K	Cam, Weighted Choke, 1981-86 Ford Escort, Fiesta
H22-68	4R-1271	Lever, Choke, Ford w/1.6L eng.
H28-107	15R-197A	Screw, Idle Mixture
H35-58	35R-1398-3A	Diaphragm, Choke, 1980-83 Ford, Lincoln, Mercury w/1.6L eng.
H75-36	29R-1313K	Pin, Air Cleaner Bracket
H118-16	300R-417A	Solenoid, Idle Fuel Shutoff, 1980-84 Ford Escort

HOLLEY

MODEL

740, 5740C, 6740C



WE145-216

C145-221

H145-223

H170-49



H170-81

H170-88

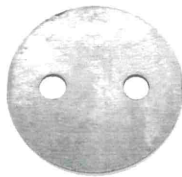

H186-54

C204-7

ACE/KS No.	OEM No.	Description
WE145-216		Tube, Canister, Ford w/4 cyl. eng. (.239 O.D. x .985" L)
C145-221		Tube, PVC, 1982 Chrysler w/1.7L eng. (3/8" O.D. x 3.075" L)
H145-223		Tube, Vacuum (.2188 O.D. x .985" L)
H170-49	47R-674, 628	Stud & Contact Assembly, Electric Choke Thermostat
H170-81	47R-674	Cover, Electric Choke Thermostat
H170-88	47R-674	Cover & Contact Assembly, Electric Choke Thermostat
H186-54	9R-282K	Plate, Throttle
C204-7		Connector, B.V.Solenoid & Electric Choke, 1981-up Ford Escort

HOLLEY

MODEL

6500, C, 6510, C, 6520



H5-44



H5-68



H10-98



H10-99



H10-100



H10-101



H10-102

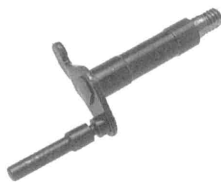

H12-47



H12-59



R15-25



H17-48



H19-4



H24-45



H28-96



H30-15

ACE/KS No.	OEM No.	Description
H5-44	37R-299K	Stud, Air Cleaner (1/4-20 thd. x 13/32" L)
H5-68	5R-1391K	Screw, Idle Stop (Use our spring H61-125)(10-32 thd. x 11/16" L)
H10-98	13R-1178K	Bushing, Primary Throttle Shaft [throttle side]
H10-99	13R-1198K	Bushing, Secondary Return Spring
H10-100	13R-1199K	Bushing, Primary Return Spring [pump side]
H10-101	13R-1228K	Bushing, Choke Shaft Housing Lever
H10-102	13R-1285K	Bushing, Primary Throttle Shaft [pump side]
H12-47	4R-1081A	Shaft, Choke Housing, 1978-79 Mustang
H12-59	3R-642AK	Lever, Choke Shaft
R15-25		Fitting, Inlet (1/8" NPT x 3/8" Nipple)
H17-48	41R-843	Cam, Fast Idle
H19-4	21R-721-50	Nozzle, Pump Discharge Spray, Pinto
H24-45	29R-1303K	Plunger, Sensor Actuator, 1981-84 Chevrolet w/1.6L eng.
H28-96		Screw, Idle Mixture, 1986 Chrysler w/2.2L eng.
H30-15		Screen, Filter (helps prevent blowback to fuel bowl)

HOLLEY

MODEL

6500, C, 6510, C, 6520



H61-125



H61-145



H115-373



H145-70



H145-195



C145-221



H170-20



H170-22

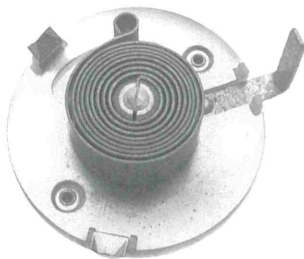

H170-23



HRP170-33



H170-42



H170-80

ACE/KS No.	OEM No.	Description
H61-125	38R-108K	Spring, Idle Stop Screw (fits our H5-68)
H61-145	38R-1817	Spring, Fast Idle Cam
H115-373	43R-753	Link, Choke
H145-70		Tube, Vacuum Conversion (1/4" O.D. to 7/16" O.D.)
H145-195		Tube, Choke Diaphragm Cover (.1875 O.D. x .047 I.D. x 7/8" L)
C145-221		Tube, PVC, 1982 Chrysler w/1.7L eng. (3/8" O.D. x 3.075" L)
H170-20	47R-487	Cover, Electric Choke
H170-22	47R-512AK	Spacer, Blue Plastic
H170-23	47R-517AK	Spring Assembly, Bi-Metal Choke
HRP170-33	47R-605A	Repair Part, Use Epoxy To Repair Connector
H170-42	47R-606AK	Thermostat, Electric Choke, 1981-84 Chrysler w/4 cyl.
H170-80		Thermostat, Electric Choke

HOLLEY

MODEL

3160, 4150, G, EG, 4160



H2-11



H5-45



H5-46



H5-64



H10-47



H10-78



H10-97



H15-37



H15-37X



H15-64



H15-64XX



H17-20



H17-56



H22-1



H22-1S

ACE/KS No.	OEM No.	Description
H2-11	23R-556K	Valve, Vent
H5-45	5R-552K	Screw, Fuel Bowl
H5-46	5R-645K	Screw, Fuel Bowl
H5-64	37R-133K	Stud, Pump Lever
H10-47	13R-513K	Bushing, Throttle Shaft Strip (1/64" x 1/8")
H10-78	7R-143-3	Restrictor, Idle (.125" O.D. x .025" orifice x .125 L)
H10-97	13R-1057K	Bushing, Throttle Shaft (w/governor) (.562 O.D. x .365 I.D. x .900 L)
H15-37	19R-457K	Fitting, Fuel Inlet (1/2-20 female inverted flare x 7/16-20 x .500 L)
H15-37X		Fitting, Fuel Inlet (1/2-20 female inverted flare x 7/16-20 x .830 L)
H15-64	19R-227K	Fitting, Fuel Inlet (5/8-18 female inverted flare x 9/16-24 x 3/4" L)
H15-64XX		Fitting, Fuel Inlet O.S. (5/8-18 female inverted flare x 5/8-24 thd.)
H17-20	41R-613K	Cam, Fast Idle
H17-56	41R-244K	Cam, Fast Idle (fits 4010, 4011 w/auto choke & 4150 models)
H22-1		Holder, Choke Cable Wire
H22-1S		Holder Only (for the H22-1)

HOLLEY

MODEL

3160, 4150, G, EG, 4160



H22-16



H24-26

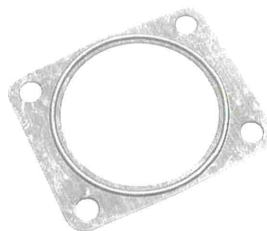

H25-8



HRP25-10



H28-21



H35-8G

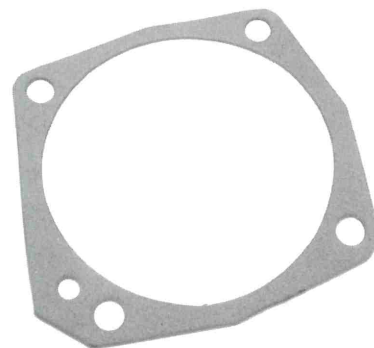

H35-8G-G

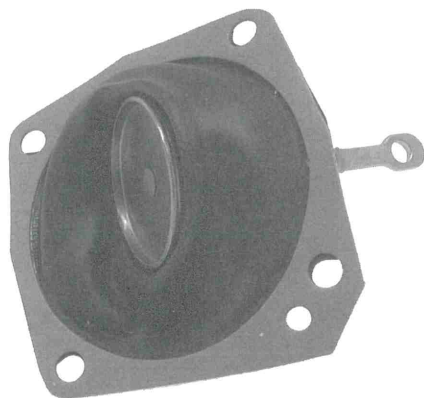

H35-9G

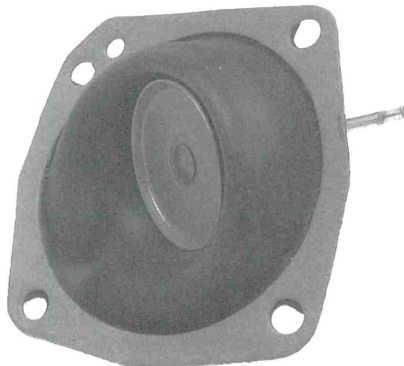

H35-15G



H35-44

ACE/KS No.	OEM No.	Description
H22-16		Holder, Choke Cable Wire
H24-26	29R-1208K	Pin, Antiperk (.093" Dia. x 11/16" L)
H25-8		Plate, Spring Steel Diaphragm Repair
HRP25-10		Fitting, Distributor Vacuum Outlet (1/8 male NPT x 3/8-24 x .565" L)
H28-21	15R-129K	Screw, Idle Mixture
H35-8G	35R-199A	Diaphragm, Secondary Pump (with gasket attached)
H35-8G-G		Gasket Only (fits our H35-8G, 9G, 15G)
H35-9G	35R-235A	Diaphragm, Secondary Pump (with gasket attached)
H35-15G	35R-747A	Diaphragm, Secondary Pump (with gasket attached)
H35-44	35R-1111AK	Diaphragm, Secondary

HOLLEY

MODEL

3160, 4150, G, EG, 4160



H47-5



H47-44



H61-82



H61-122



H63-14



H63-25



H63-40



H108-16



H108-27



H108-38



H115-160



H115-164



H115-198



H115-223



H115-225

ACE/KS No.	OEM No.	Description
H47-5	7R-107	Plug, Main Metering Body, 1957-61 Ford (1/4" Dia.)
H47-44	25R-620BK	Plug, Power Valve
H61-82	38R-757K	Spring, Float
H61-122	38R-684K	Spring, Secondary Diaphragm, 1975-80 Ford Truck
H63-14	41R-218K	Cam, Accelerator Pump (white)
H63-25	41R-427K	Cam, Accelerator Pump (blue)
H63-40	41R-290K	Cam, Accelerator Pump (green)
H108-16	41R-546	Washer, Flat (.305 O.D. x .116 I.D. x .015 thk.)
H108-27	46R-1021K	Lockwasher, Spring Bushing
H108-38	8R-657K	Washer, Float Bowl Screw (plastic)
H115-160	33R-540K	Link, Choke Diaphragm
H115-164	43R-399, 529	Link, Fast Idle
H115-198	33R-475K	Link, Vacuum Brake
H115-223	43R-363K	Link, Choke (has groove for retainer)
H115-225	43R-363K	Link, Choke

HOLLEY

MODEL

3160, 4150, G, EG, 4160



H115-253



H115-254



H145-2



H145-59



H145-70



H145-87



H145-132



H145-133



H145-202



H145-248



H150-3



H150-4

ACE/KS No.	OEM No.	Description
H115-253	43R-205	Link, Secondary Throttle
H115-254	43R-426	Link, Throttle
H145-2	14R-320	Tube, Fuel Transfer, 1957-62 Ford
H145-59		Tube, Pump Passage (with o-rings)(1/4" dia. x .780" L)
H145-70		Tube, Vacuum Conversion (1/4" O.D. to 7/16" O.D.)
H145-87		Tube, Distributor Vacuum (3/16" O.D.)
H145-132		Tube, Air Horn (short)
H145-133		Tube, Air Horn (long)
H145-202		Tube, Vent (7/16" O.D.)
H145-248	14R-370K	Tube, Fuel Line
H150-3	36R-169K	E-Clip (3/32")
H150-4	36R-225K	E-Clip (5/64")

HOLLEY

MODEL

3160, 4150, G, EG, 4160



H150-22

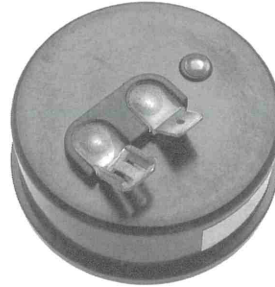

H170-113

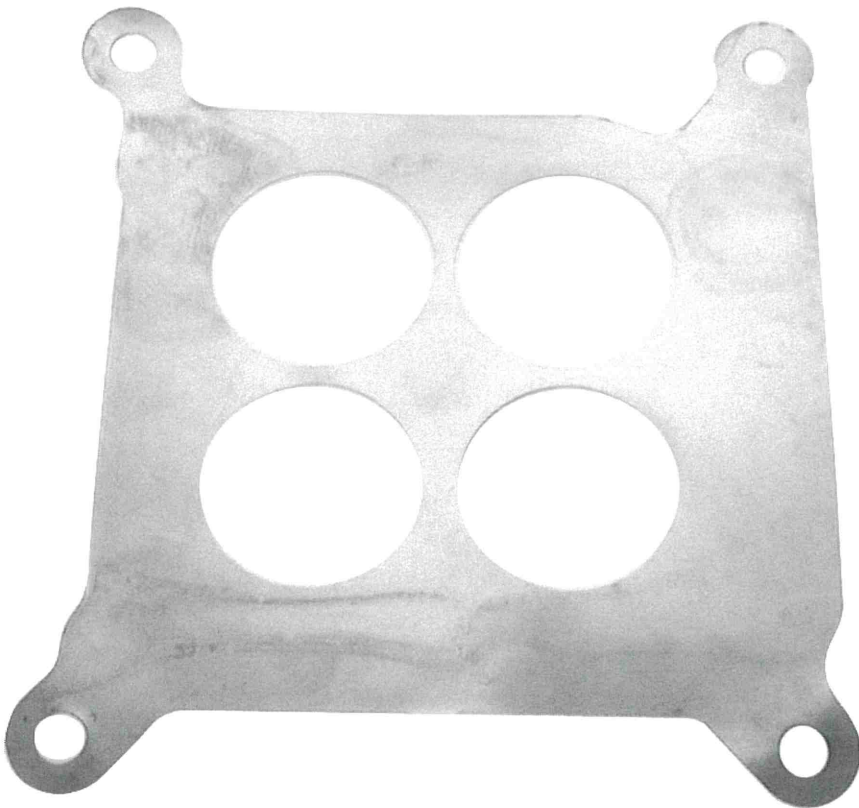

H186-11



RT-12

ACE/KS No.	OEM No.	Description
H150-22		E-Clip (1/8")
H170-113	47R-669AK	Thermostat, Electric Choke
H186-11	3884575	Plate, Baffle
RT-12		Tap, Bottoming (5/8-24 -- for our H15-64XX)

HOLLEY

MODEL

4180, C, EG, 4190EG



H5-45



H5-46



H10-97



H17-53



H17-54



H17-55

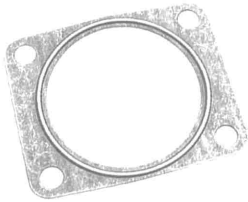

H25-8



H63-14



H63-25



H63-40



H108-38



H115-373



H145-189



H145-202

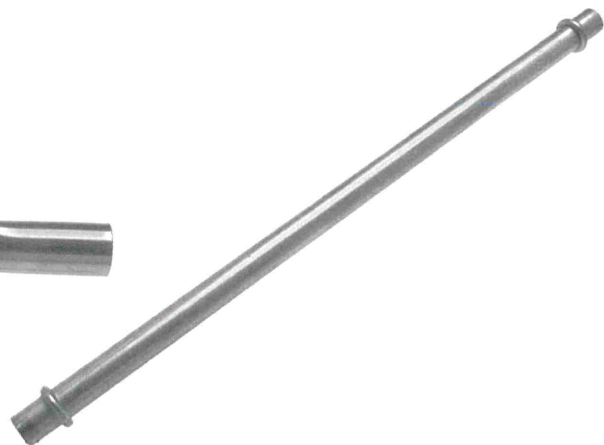

H145-248

ACE/KS No.	OEM No.	Description
H5-45	5R-552K	Screw, Fuel Bowl (primary)
H5-46	5R-645K	Screw, Fuel Bowl (secondary)
H10-97	13R-1057	Bushing, Throttle Shaft (w/governor)(.562 O.D. x .365 I.D. x .900 L)
H17-53	41R-939AK	Cam, Fast Idle (4180C -- non-weighted version)
H17-54	41R-935AK	Cam, Fast Idle (4180C -- weighted version)
H17-55	41R-931AK	Cam, Fast Idle (4180C -- non-weighted version)
H25-8		Plate, Spring Steel Diaphragm Repair
H63-14	41R-218	Cam, Accelerator Pump (white)
H63-25	41R-427	Cam, Accelerator Pump (blue)
H63-40	41R-290	Cam, Accelerator Pump (green)
H108-38	8R-657K	Washer, Float Bowl Screw (plastic)
H115-373	43R-753	Link, Choke
H145-189		Tube, Bowl Canister (1/4" O.D. x 2-9/16" L)
H145-202		Tube, Vent (7/16" O.D.)
H145-248	14R-370K	Tube, Fuel Line (6.00" L)

HOLLEY

MODEL

4010, 4011, 4500



H10-103



H17-56



H186-55

ACE/KS No.	OEM No.	Description
H10-103	13R-1066K	Bushing, Primary Throttle Shaft (4010, 4011)
H17-56	41R-244K	Cam, Fast Idle (fits 4010 & 4011 w/auto choke & 4150 models)
H186-55	9R-228	Plate, Throttle (4500)

*Let us help you with all your fuel
system requirements
with high-quality products
available from*



*Fuel system components for the
Quality Conscious Rebuilder!*



Hwy. 69 South / P.O. Box 151 / Columbus, KS 66725
Phone 800-325-3888 / FAX 800-231-1469
Phone 316-429-1000 / FAX 316-429-1003